

|        |      |                         |         |                                   |               |                 |
|--------|------|-------------------------|---------|-----------------------------------|---------------|-----------------|
| Rev By | Date | Description Of Revision | Rev No. | Drawing Title: Single 3Hinge Door |               |                 |
|        |      |                         |         | Contract: TBC                     |               |                 |
|        |      |                         |         | Scale: NTS                        | Requested By: | Drawn By: IS    |
|        |      |                         |         | Initial Drawing:                  | Revision: 0   | Drawing No. TBC |

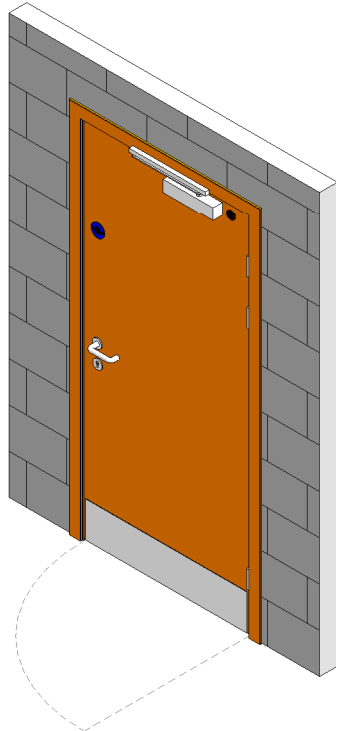

**Foris Solutions Limited**  
 Unit 7 Bookers Way,  
 Todwick Road Industrial Estate,  
 Dinnington, Sheffield, S25 3SH.  
 Tel: 01909 560500  
 sales@foris-solutions.co.uk  
 www.foris-solutions.co.uk



**01 3D External View**

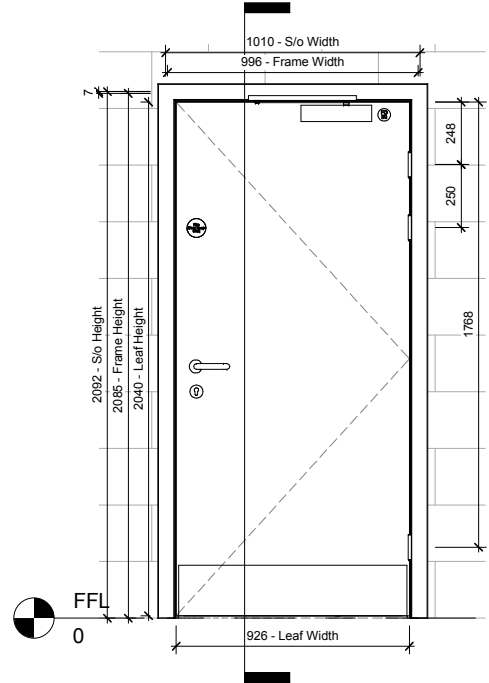

**02 Pull Face**  
1 : 20

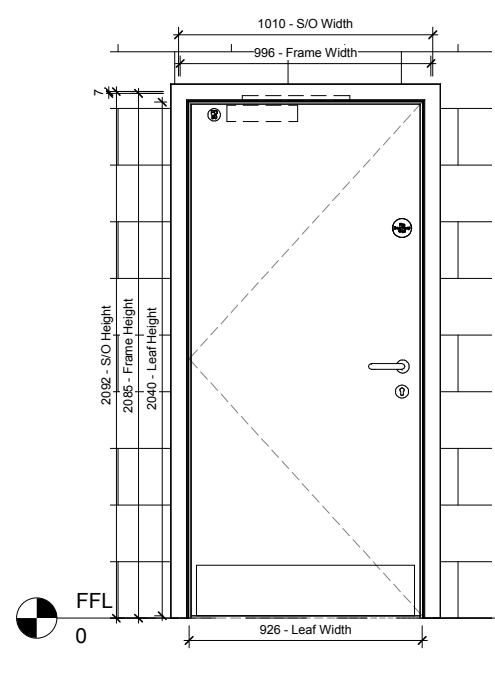

**03 Push Face**  
1 : 20

**04 Head Detail**  
1 : 5

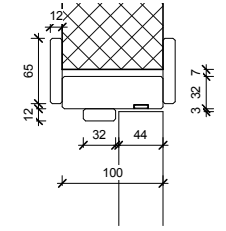

**05 Undercut Detail**  
1 : 5

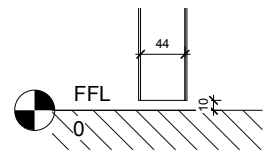

**06 Jamb Detail**  
1 : 5

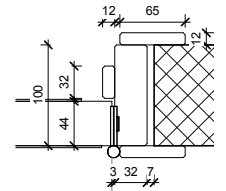

| Door Schedule    |                                  |            |            |           |             |            |             |                |               |          |          |                        |                |                   |                          |                |            |              |                 |              |                |                    |                     |                    |               |               |            |               |             |     |                |
|------------------|----------------------------------|------------|------------|-----------|-------------|------------|-------------|----------------|---------------|----------|----------|------------------------|----------------|-------------------|--------------------------|----------------|------------|--------------|-----------------|--------------|----------------|--------------------|---------------------|--------------------|---------------|---------------|------------|---------------|-------------|-----|----------------|
| Description      | RoomName                         | DoorNumber | S/o Height | S/o Width | FrameHeight | FrameWidth | Frame Depth | FrameThickness | LeafThickness | Undercut | DoorCore | ExposedOrConcealedLips | DoorFacingType | DoorFacingSpecies | DoorFacingCut/ Reference | LippingSpecies | FireRating | Operation    | DoorHanding     | HingePivotNo | HingePivotType | FirstHingePosition | SecondHingePosition | ThirdHingePosition | FrameRequired | FrameMaterial | Frame Type | BillableHours | BatchNumber | #B  | Ironmongeryset |
| Single Leaf Door | Open in Access Controlled Office | SA10.3     | 2092       | 1010      | 2085        | 996        | 100         | 32             | 44            | 10       | TBC      | TBC                    | TBC            | TBC               | TBC                      | TBC            | FD30S      | Single Swing | Right Hand Hung | 3            | TBC            | 248                | 498                 | 1768               | Yes           | TBC           | PSE Frame  |               | N/A         | TBC |                |

© All items on this drawing are the property of Foris Solutions LTD and as such are copyrighted by them. No drawing should be copied, edited or retained by another party unless prior written permission is obtained. All scales attached to this drawing are meant as a guide and as such this document should not be scaled from. All dimensions where it is applicable should be checked on site by the contractor prior to commencement of any work.