

Rev By	Date	Description Of Revision	Rev No.	Drawing Title: Single 3Hinge Door		
				Contract: TBC		
				Scale: NTS	Requested By:	Drawn By: IS
				Initial Drawing:	Revision: 0	Drawing No. TBC

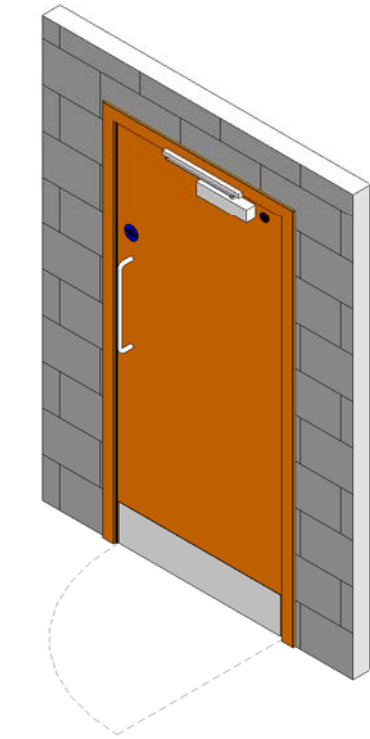

Foris Solutions Limited
 Unit 7 Bookers Way,
 Todwick Road Industrial Estate,
 Dinnington, Sheffield, S25 3SH.
 Tel: 01909 560500
 sales@foris-solutions.co.uk
 www.foris-solutions.co.uk



01 3D External View

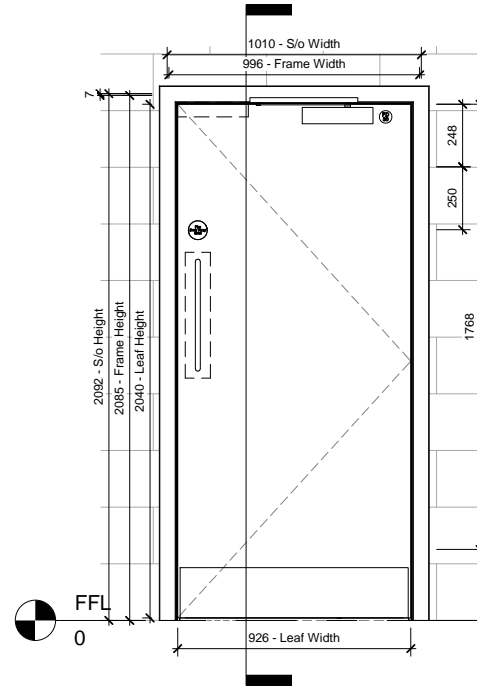

02 Pull Face
1 : 20

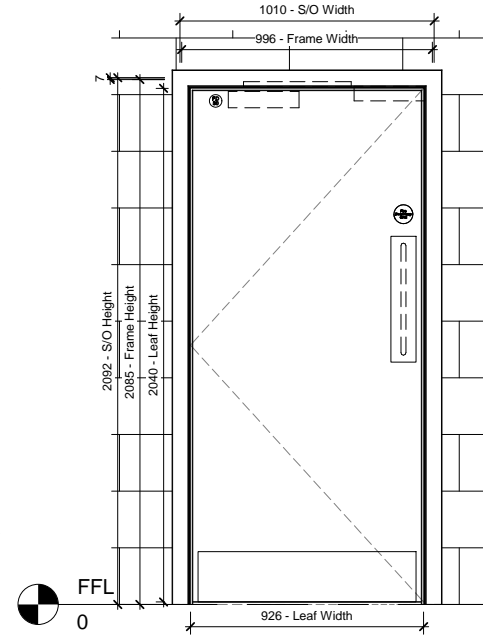

03 Push Face
1 : 20

04 Head Detail
1 : 5

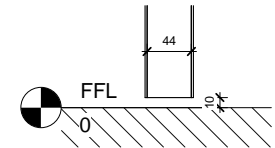
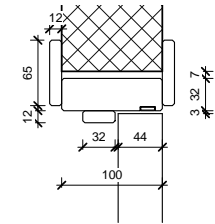

05 Undercut Detail
1 : 5

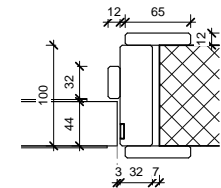

06 Jamb Detail
1 : 5

Door Schedule																															
Description	Room Name	Door Number	S/O Height	S/O Width	Frame Height	Frame Width	Frame Depth	Frame Thickness	Leaf Thickness	Undercut	Door Core	Exposed Or Concealed Lips	Door Facing Type	Door Facing Species	Door Facing Cur / Reference	Lipping Species	Fire Rating	Operation	Door Handing	Hinge/Pivot No	Hinge/Pivot Type	First Hinge Position	Second Hinge Position	Third Hinge Position	Frame Required	Frame Material	Frame Type	Billable Hours	Batch Number	dB	Ironmongery set
Single Leaf Door	Open in Access Control Office	SA8.3	2092	1010	2085	996	100	32	44	10	TBC	TBC	TBC	TBC	TBC	TBC	FD30S	Single Swing	Right Hand Hung	3	TBC	248	498	1768	Yes	TBC	PSE Frame		N/A	TBC	